

GATEWAY CROSSINGS

10410-10496 Roosevelt Blvd. & 9th Street • St. Petersburg, FL 33716

County: Pinellas • Type: Grocery Anchored • Built: 1990

Total Square Feet: 87,308 • Parking Spaces: 512

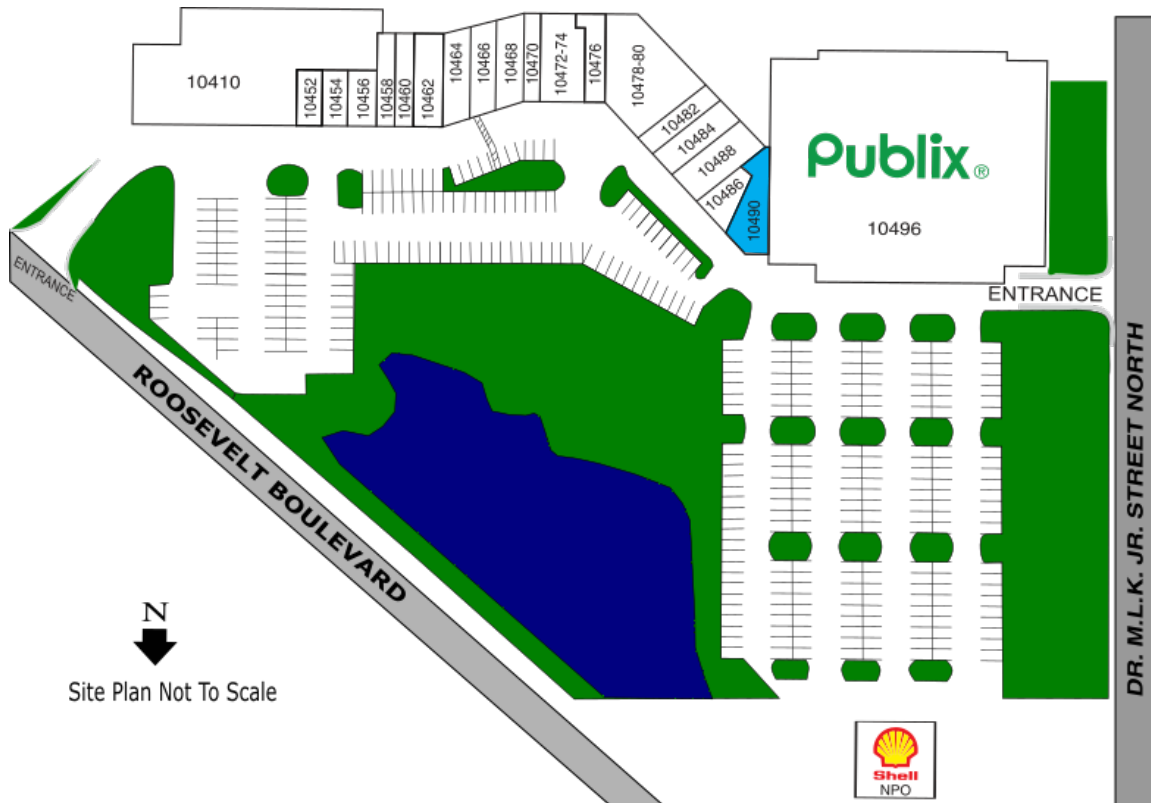

CURRENT TENANTS

| | | | |
|-------|----------------------------------|----------|---------------------------------|
| 10410 | Epic Fitness | 10470 | General Nutrition Center #7626 |
| 10452 | Written in Blood Ink | 10472-74 | Greenberg Dental & Orthodontics |
| 10454 | The Skinny Dip Frozen Yogurt Bar | 10476 | China Crossings |
| 10456 | Afterglow Tanning | 10478-80 | Que Pasa Mexican Cantina |
| 10458 | Sun Country Cleaners | 10482 | Gateway Liquors |
| 10460 | The UPS Store #1331 | 10484 | Slice of The Burg |
| 10462 | Tobacco Depot #725 | 10488 | Signature Nails and Spa |
| 10464 | DBK Hair Salon | 10486 | Happy Flamingo Gift Shop |
| 10466 | Yummy Thai | 10490 | AVAILABLE - 1,736 SF |
| 10468 | Cosmic Donuts | 10496 | Publix Super Market #395 |

Bruce Strumpf, Inc.

Licensed Real Estate Broker Since 1980

2120 Drew Street
Clearwater, FL 33765
Phone: 727-449-2020
Fax: 727-449-2212
www.brucestrumpf.com